



Association of  
Licensed Architects

\$6.00  
Volume 18, No. 4  
Winter 2014

# Licensed Architect

A Publication of the Association of Licensed Architects

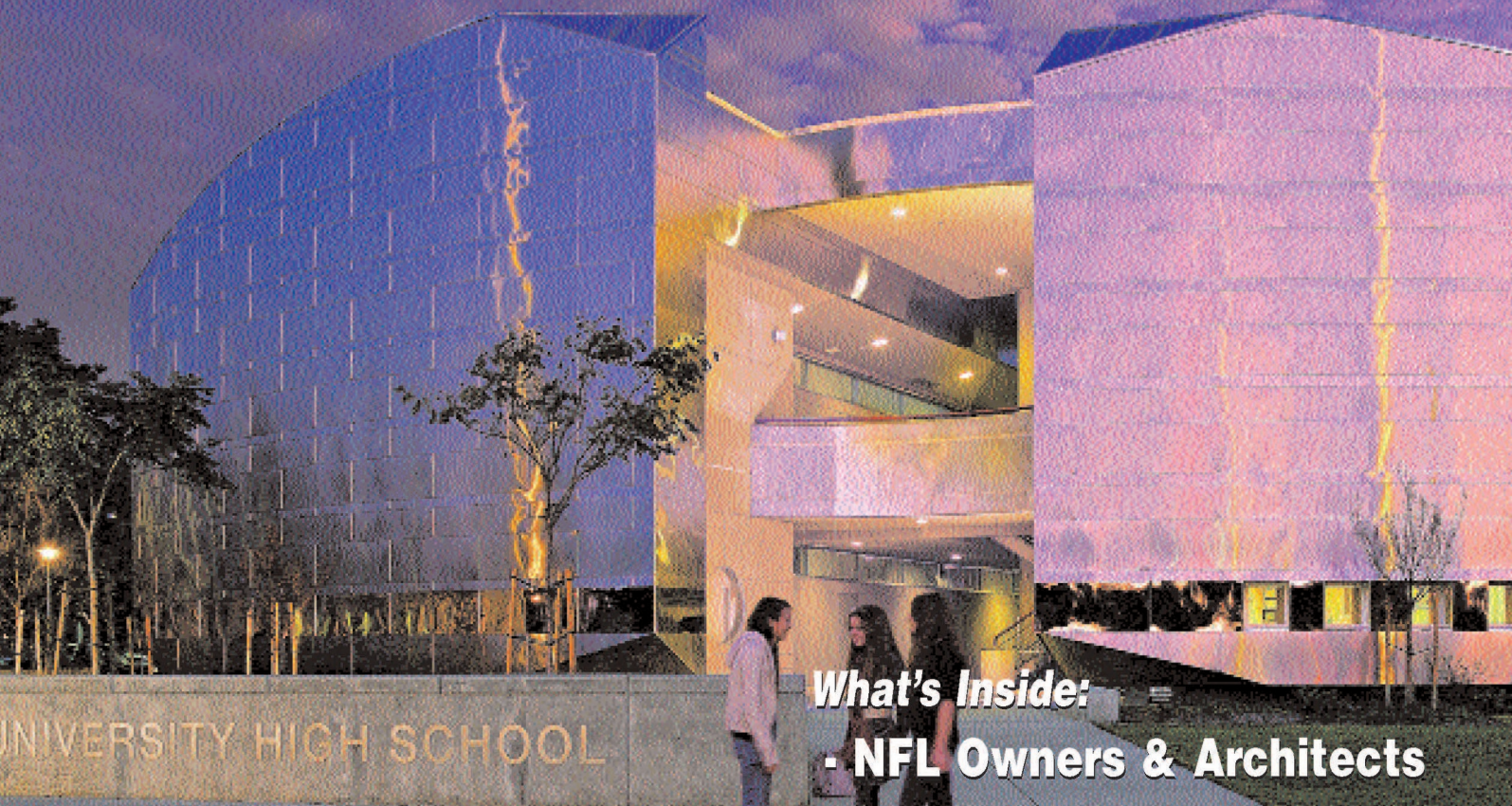

## ***What's Inside:***

- **NFL Owners & Architects**
- **CE Article:  
Geothermal Heat Pump  
Technology**
- **Firm Management:  
Beyond Intuition**
- **2014 ALA Design  
Award Winners**

ALA  
One East Northwest Hwy, Suite 200  
Palatine, IL 60067  
Change Service Requested

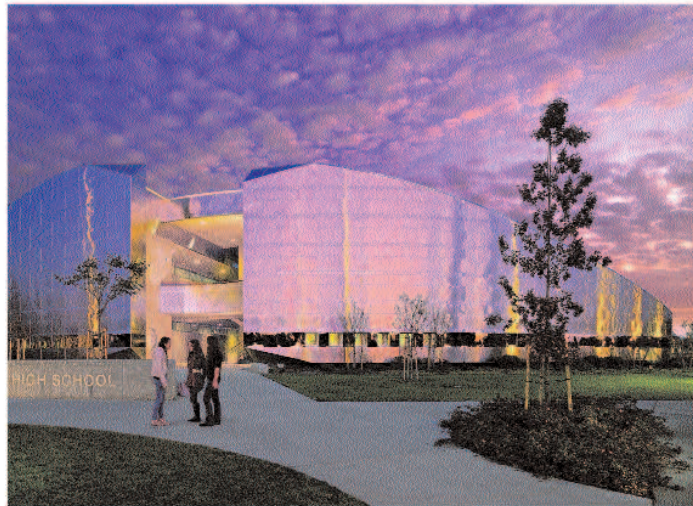

*On the Cover*

**University High School**  
Fresno, CA

**Firm:**

Dyson Siegrist Janzen Architects, Inc.,

This bold, new Charter School provides a 21st Century learning and teaching environment developed with evidence-based design principles to enhance retention, comprehension, attitude, pride and safety. Shapes, materials, colors, textures, scale and pattern all play a major role visually and psychologically on student performance.

*Photography: Paul Mullins Studio*

D2C is proud to  
have been a part of the  
Fieldstone House project.

Best wishes and  
continued success to  
Bruns Architecture

[www.design2construct.com](http://www.design2construct.com)

# 2014 ALA Design Award Winners 15

**FEATURES**

- |   |                             |
|---|-----------------------------|
| <b>14</b> ADA Advice                            | <b>12</b> Firm Management   |
| <b>6</b> ALA New Members                        | <b>44</b> Golf Outing       |
| <b>45</b> ALA Midwest Conference & Product Show | <b>34</b> Insurance Info    |
| <b>47</b> Chapter News                          | <b>10</b> Legal Issues      |
| <b>8</b> Code Corner                            | <b>42</b> Membership        |
| <b>36</b> Continuing Education                  | <b>4</b> President's Letter |

**ARTICLES**

- The Timeline of the Building Code** **8**  
How did we get to a single code? Enjoy this short history lesson.  
*by Kelly P. Reynolds, ALA Code Consultant*
- The Expanding Scope of Liability for Condominium Projects** **10**  
Learn why architects working on condominium projects should consider purchasing additional insurance coverage.  
*by Shawn E. Goodman, Sabo & Zahn, Attorneys at Law*
- Firm Management: Beyond Intuition Part 1 – The Basics** **12**  
Intuition has its limits as a financial management tool. Learn how to track financial indicators pertinent to your firm's current health and forecasting its future.  
*by Rena M. Klein, FAIA, RM Klein Consulting*
- ADA Advice: Audible and Visible Alarms Primer** **14**  
All persons and situations must be considered when specifying a fire alarm system.  
*by Kimberly Paarlberg, RA, Senior Staff Architect, ICC*
- The ALA 2014 Design Awards Winners** **15**  
View the winning entries of this year's design awards competition.
- NFL Owners & Architects** **34**  
Learn how Acceptance/Rejection Protocols could best serve Architects.  
*by Robert G. Stanton, CPCU, ARM, RPLU, Willis A&E*
- Continuing Education: Geothermal Heat Pump Technology** **36**  
Earn 1.0 LU in HSW while learning about geothermal heat pump technology and installation considerations.  
*by Scott Niesen, WaterFurnace International, Inc.*
- ALA Midwest Architecture Conference & Product Show** **45**

## 2014 Design Award Program

On September 12th, five well-respected architects studied every entry and selected the winning projects for the 2014 ALA Design Award Program. Out of 113 entries, 13 projects were recognized with an **Award of Merit**, 17 projects were awarded a **Silver Medal**, and 5 projects a **Gold Medal**, with the top honor being the **Don Erickson Presidential Award**.

Projects were entered in eight categories: Residential I, Residential II, Commercial/Industrial, Interior Architecture, Institutional, Religious, Renovation and Unbuilt Design. Each entry was judged on its own merit based on: Program Solution, Site and Space Planning, Overall Design Solution and Construction System and Details.

LeRoy B. Herbst III, FALA of *L.B. Herbst & Associates* served as jury chairperson. Rich Barnes, ALA of *Barnes Architects, Ltd.* and Matthew Kramer, ALA of *Matthew Kramer Architects* were assistant chairpersons.

**ALA would like to thank our Design Award Program Sponsor:**

• Andersen Windows

**And our Banquet Sponsors:**

• Moen International and WaterFurnace

**ALA wishes to thank the following judges for their hours of volunteer time and their dedication to the program and profession:**



### **Pamela J. Hutter, ALA, AIA, CSI**

Pamela J. Hutter, ALA, AIA, CSI, Principal of Hutter Architects, is a Chicago area native who was born into a milieu of designing and building. After graduating from the University of Illinois, Urbana, her career included working for a national design-build construction company as a field superintendent where she traveled the country as a builder of commercial and industrial projects. Her passion has always been for the historic, the sustainable, and a design that is contextual. She brings a disciplined process to her projects that typically involves adaptive re-use and includes as many nurturing single-family homes as industrial projects.



### **Walker C. Johnson, FAIA**

Walker Johnson is a founding principal at Johnson Lasky Architects in Chicago, IL. With more than 40 years of specialized experience in historic preservation, Walker has served three terms on the Illinois Historic Sites Advisory Council to the State Historic Preservation Office and is an active member on the Board of Landmarks Illinois. Firm projects include Memorial Stadium and Illini Union at the University of Illinois Urbana/Champaign, the Naper Settlement in Naperville, IL and St. Johns Church, Quincy, IL. A licensed architect in five states, Walker earned his Bachelor of Architecture from the University of Illinois and B.S. in History at University of Wisconsin.



### **John Moorhead, LEED AP BD+C**

John Moorhead has over twenty years of experience in architecture and currently serves as Senior Project Architect and Healthcare Practice Chair at Perkins+Will. John played a key role in shaping the new hospital tower at Rush University Medical Center, one of the largest LEED Gold certified hospitals in the world. John obtained a Bachelor of Architecture from the Illinois Institute of Technology with high honors as the Henry Adams Medal recipient. He is a registered architect in the state of Illinois and a LEED Accredited Professional with a specialty in building design and construction.



### **Michael J. Sobczak, ALA, AIA, NCARB, ASID, IIDA**

A graduate of the University of Wisconsin-Milwaukee with both bachelor and master degrees in architecture, Michael joined Plunkett Raysich Architects, LLP in 1991. He currently serves as a Partner of the firm and is responsible for overseeing the design aspects of each project. With nearly 25 years of architectural and interior design experience, Michael's project experience spans a variety of types, from corporate headquarters and municipal institutions to educational facilities and residential developments. His designs have earned numerous prestigious industry awards including accolades from the Association of Licensed Architects (ALA), American Institute of Architects (AIA), the American Society of Interior Designers (ASID) and the International Interior Design Association (IIDA).



### **John Weigand, AIA**

John Weigand is Professor and Chair in the Department of Architecture + Interior Design at Miami University (Ohio). He earned architectural degrees at Miami and at the University of Illinois and worked professionally in Chicago from 1980 to 1991 prior to teaching. At Miami, Weigand developed the BFA in Interior Design and directed the BFA program. He has participated in numerous initiatives addressing collaborative design education and practice. He is author of *The Nature of Design*, an interdisciplinary text on design fundamentals, which received the AIGA Award of Merit in 2004. Weigand was listed among the "DesignIntelligence 25 Most Admired Educators of 2012."